

SHEET No. 1
 PLAN No. 1700
 FOR
SEPULVEDA AVENUE SEWER
 FROM
 MARSHALL BLVD. TO 34th STREET
 CITY OF SAN BERNARDINO
 CALIFORNIA

MAY 1947

R. D. FORSYTHE
 ACTING CITY ENGINEER

PLAN ADOPTED July 21, 1947

FILED
 JUL 22 1947
 R. D. FORSYTHE

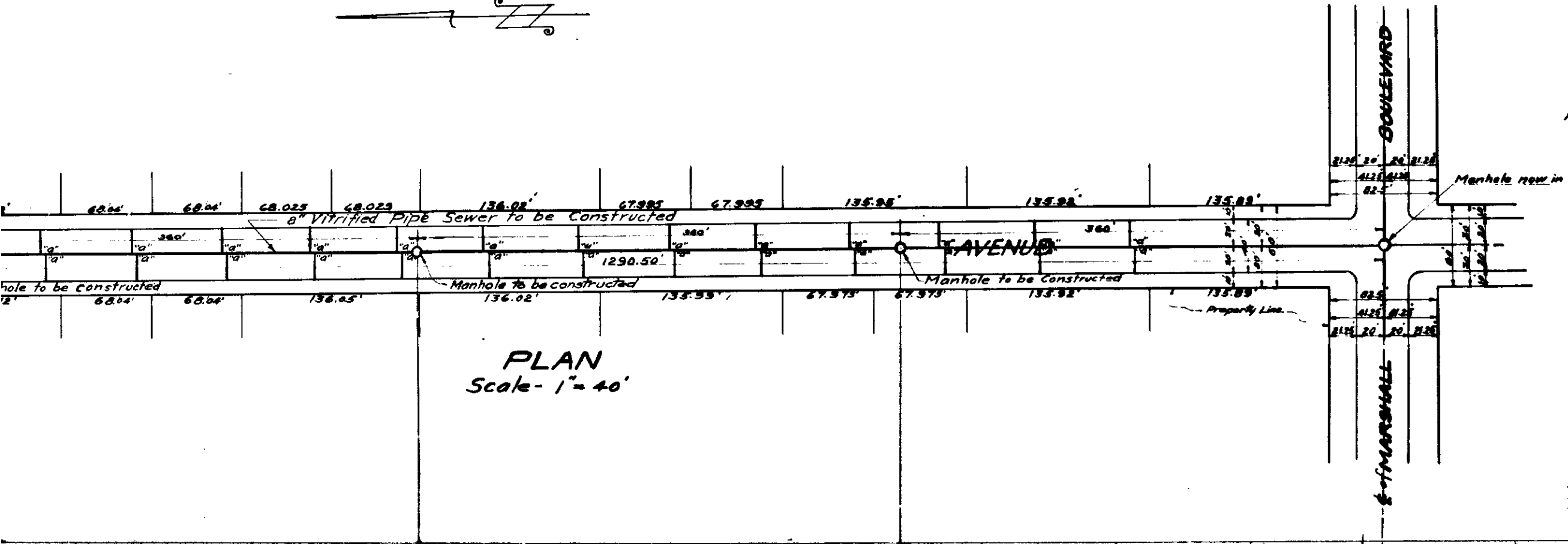
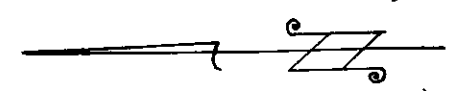

PLAN
 Scale - 1" = 40'

LEGEND

- " or ' means inch or inches.
 - ' or ' means foot or feet.
 - N# means number
 - C# means Center line
 - E.L. means Elevation
 - 8" Vitrified Pipe Sewer to be constructed, shown thus
 - 3" x 4" Wyes with 4" Connecting Sewers to be constructed, shown thus
 - Manholes to be constructed shown thus
 - Manholes now in, shown thus
 - 8" Vitrified Pipe Sewer now in, shown thus
- St. means Street
 Ave. means Avenue
 Blvd. means Boulevard
 Calif. means California

SEWER DETAIL

- Lineal Ft. of 8" Vitrified Pipe Sewer to be constructed
- Lineal Ft. of 3" x 4" Vitrified Pipe Sewer to be constructed
- N# of 3" x 4" Wyes with 4" Connecting Sewers to be constructed
- N# of Manholes to be Constructed

TITLE TO STREETS

SEPULVEDA AVENUE - From Marshall Blvd. to 34th Street, was dedicated as (LYNNE STREET) by Map of GARDEN ESTATES TRACT 1703, recorded in Book 85 of Maps of Pages 9 and 10, records of San Bernardino County, California. Name changed from LYNNE STREET to SEPULVEDA AVENUE by Resolution No. 163 of the City of San Bernardino.

GRADE RESOLUTION

Grade of SEPULVEDA AVENUE was established by Resolution 118100 of the City of San Bernardino, California.

DATA

All Elevations shown in Red ink are in feet and are above a plane which is 1045.20 feet below the City Bench Mark as established by Ordinance No. 383 of the City of San Bernardino, California.

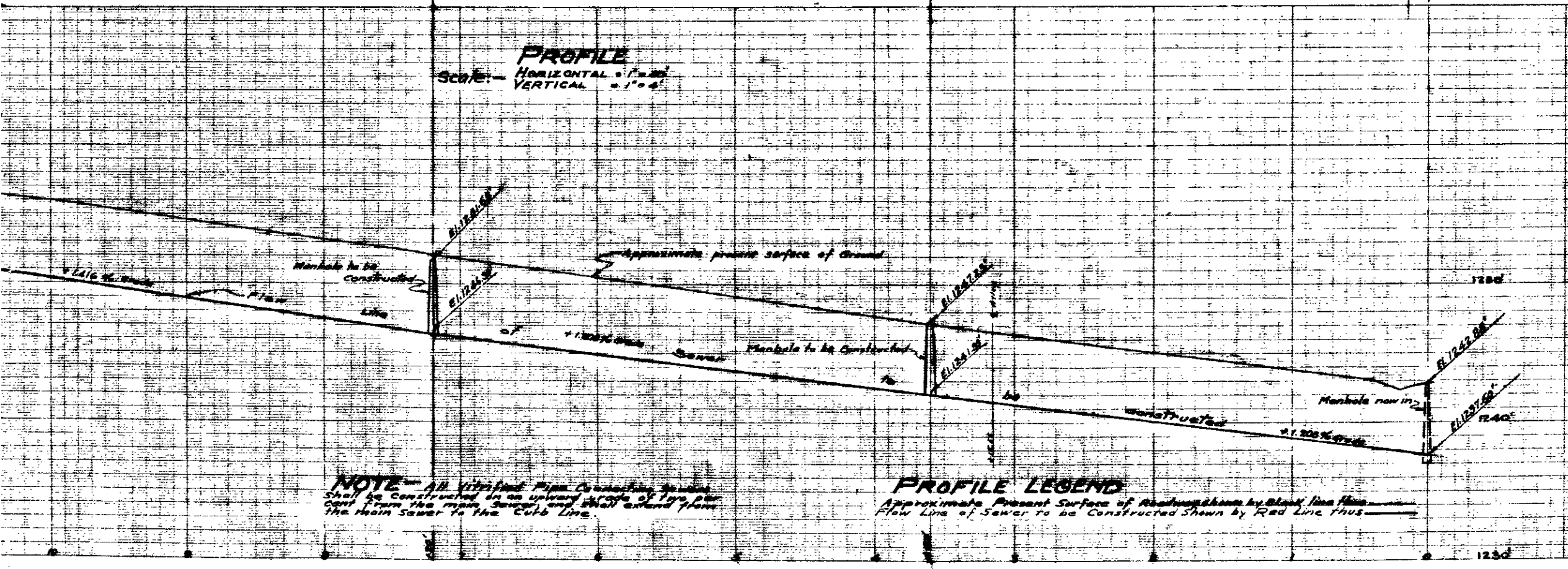

PROFILE
 Scale: HORIZONTAL = 1" = 20'
 VERTICAL = 1" = 4'

PROFILE LEGEND

- Approximate Present Surface of Roadway shown by Black Line from
- Flow Line of Sewer to be Constructed Shown by Red Line thus

NOTE - All Vitrified Pipe Connections to be constructed shall be constructed in an upward grade of 1% per foot from the main sewer, and shall extend from the main sewer to the curb line.